

H

H

G

G

F

F

E

E

D

D

C

C

B

B

A

A

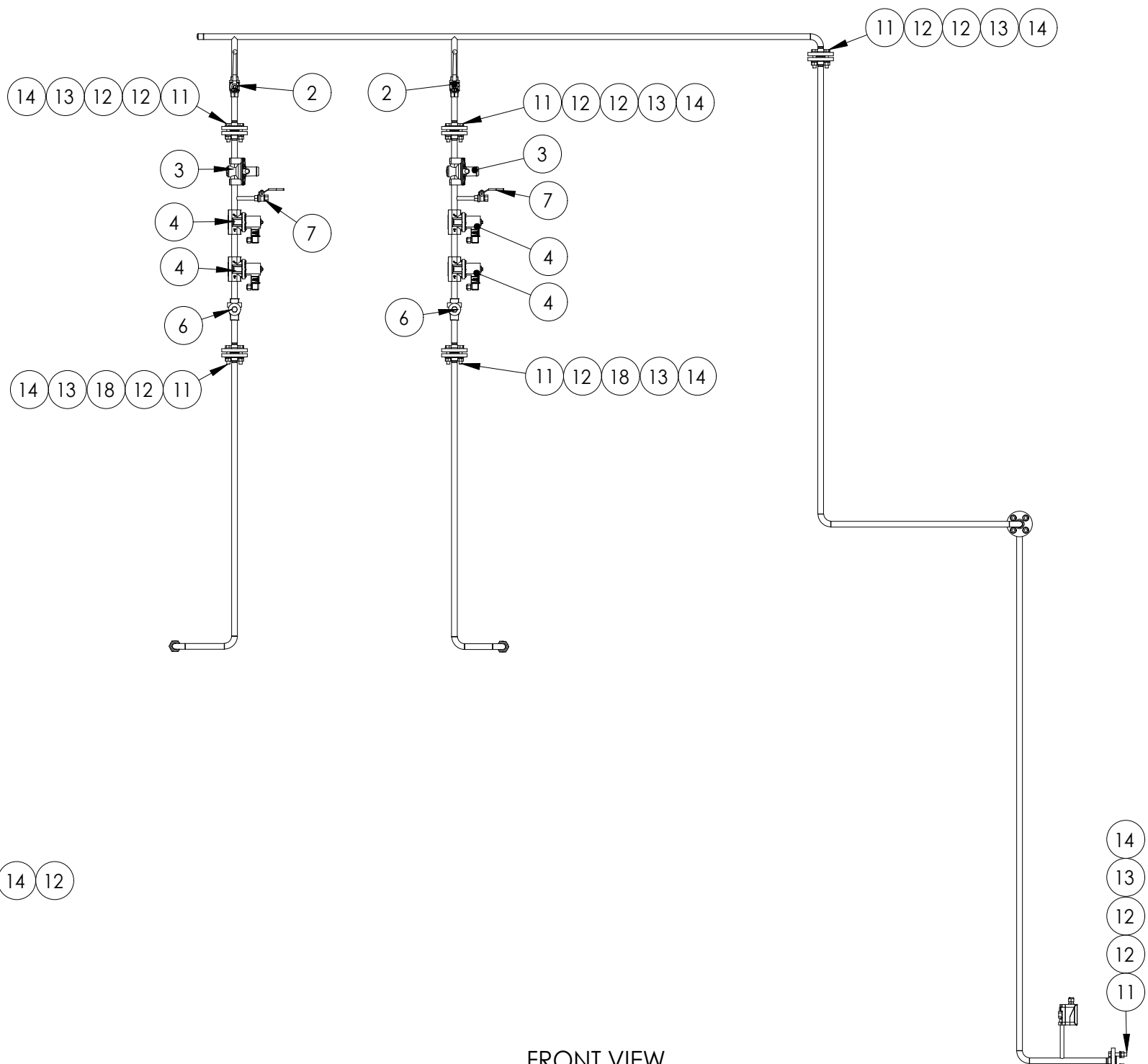
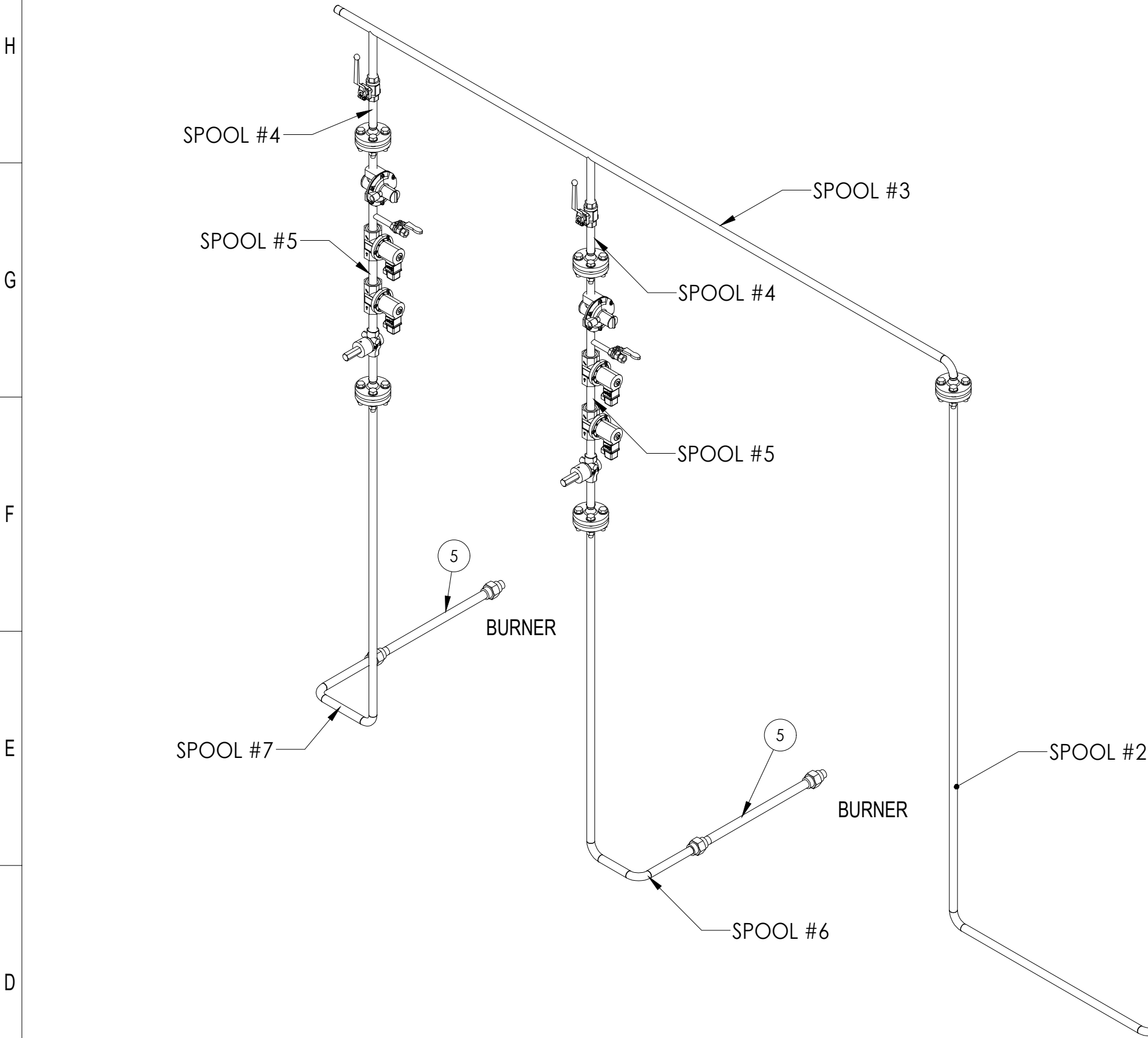

FRONT VIEW

14	DIN934-M12-8	A	NUT M12	8			0.02	28	0.56
13	DIN127-M12-ST	A	WASHER M12	ST			0.00	28	0
12	DIN125-M12-ST	A	WASHER M12	ST			0.01	56	0.56
11	DIN933-M12X60-8.8	A	BOLT M12X60	8.8			0.07	28	1.96
10	DIN 2690		GASKET - KLINGERSIL C-4430 - 3 THK. - DN15	FIBERGLASS W/NBR			-	7	0
9	EN 10216-1 - P235TR1		TUBE 1/4" - 1.8 THK - SEAMLESS	CARBON STEEL			0	293.49mm	0
8	EN 10216-1 - P235TR1		TUBE 1/2" - 2 THK - SEAMLESS	CARBON STEEL			0	11523.8mm	0
7	PID 870		BALL VALVE 1/4"	COMMERCIAL			0.20	2	0.4
6	PID 60	-	ADJUSTMENT VALVE 1/2" FOR NATURAL GAS AND AIR. THREAD DESIGN MAX OPERATION PRESSURE 10 BAR. FOR AIR AND GAS TEMP. -20°C UP TO +60°C	COMMERCIAL			1.26	2	2.52
5	PID 220		FLEXIBLE HOSE 1/2" LENGTH 500 mm CONNECTION ONE SIDE MALE THREAD ONE SIDE THREADED JOINT WITH DVGW CERTIFICATE	CARBON STEEL			2.23	2	4.46
4	PID 100	-	SOLENOID VALVE 1/2" POWERLESS CLOSED, FAST OPENING, FAST CLOSING, FOR NAT. GAS, TOWN GAS, LIQUID GAS AND AIR. CLASS A ACC EN 161 EG CERTIFICATE THREAD CONNECTION PE MAX. 100 MBAR POWER SUPPLY: 230 V~ 50/60 Hz LOW NOISE OPERATION	COMMERCIAL			2.05	4	8.2
3	PID 95		PRESSURE REGULATOR OUTLET PRESSURE: -25 - 75 MBAR SPRING REACTING, FOR CONSTANT PRESSURE FOR GAS; MEASURING CONTROL NOZZLE IN THE INLET EG CERTIFICATE PE MAX 400 MBAR	COMMERCIAL			2.55	2	5.1
2	PID 26-90-190	-	BALL VALVE FOR CONDENSATE FOR MANUAL OPERATION IN GAS, AIR, WATER AND OIL RP THREAD; PE MAX 16 BAR ENVIRONMENTAL TEMP. -20°C TO +60°C EG APPROVAL AND CERTIFICATE	COMMERCIAL			0.67	2	1.34
1	PID 89		PRESSURE SWITCH RANGE 30 - 150 MBAR, OVERPRESSURE, VACUUM AND DIFFERENTIAL PRESSURE EL. CONNECTION WITH SCREW TERMINAL MANUAL ADJUSTMENT OF SET POINT EG CERTIFICATE.	COMMERCIAL			-	1	0
Nº	PART NUMBER / ARTICLE CODE	REV.	DESCRIPTION	MATERIAL	MANUFACTURER	TAG	WEIGHT (KG)	QTY.	TOTAL WEIGHT (KG)

SPOOL #1

FLEXIBLE

Rev.	Modification				Name	Date						
This drawing is property of INSERTEC. Must not be copied or transferred to third parties in any way without written authorization.												
Tolerance for dimensions without tol. according to ISO 2768-mK				Name	Date	Material						
More than	0.5	3	6	30	120	400	1000	2000	Draw	J.J.R.R	01/12/2025	CARBON STEEL
Less	3	6	30	120	400	1000	2000	4000	Checked	O.A.P.M.	01/12/2025	Weight (kg)
Machine Tool	± 0.1	± 0.1	± 0.2	± 0.3	± 0.5	± 0.8	± 1.2	± 2	Verified	B.U.	02/12/2025	50
Welded	± 0.5		± 1	± 1.5	± 2	± 3	± 4	± 6	Title			
Customer:				Format: A2		ALINVEST						
				Scale: 1:20		TMT (FVRB-2,7-25) IGNITION ROUTE						
Project Methode:				Part Number		Revision						
insertec Furnaces & Refractories				2558-3321-TMT-CBS01-GEN01-21		B						
				Customer Number		Sheet						
				-		1/2						

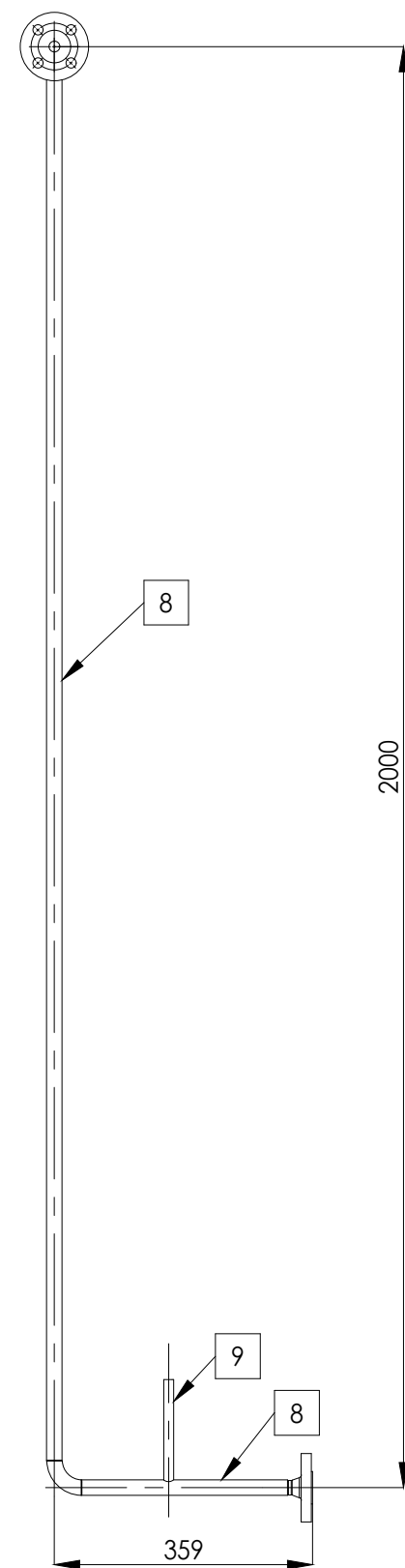

SPOOL #1 - QTY: 1

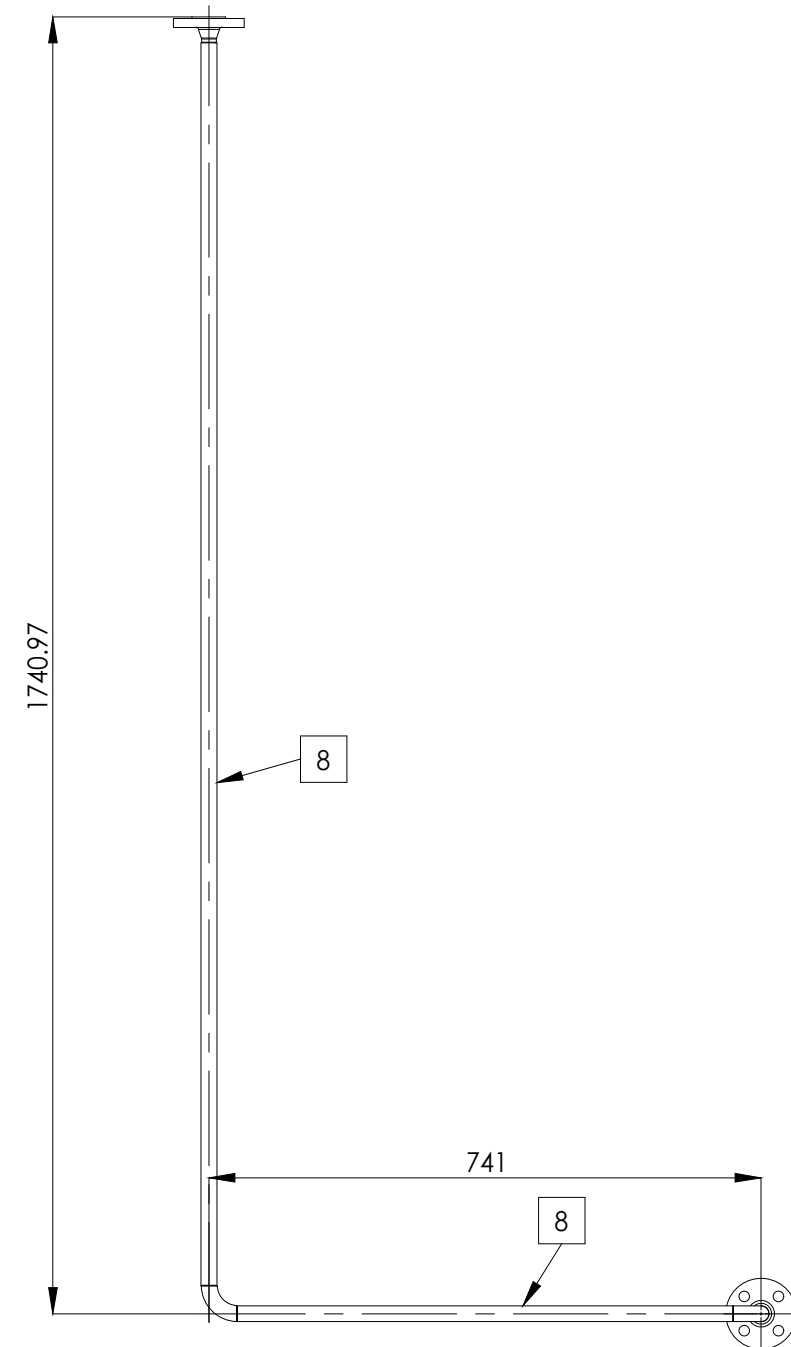
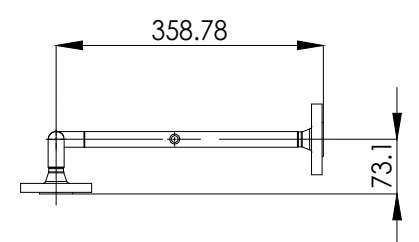

SPOOL #2 - QTY: 1

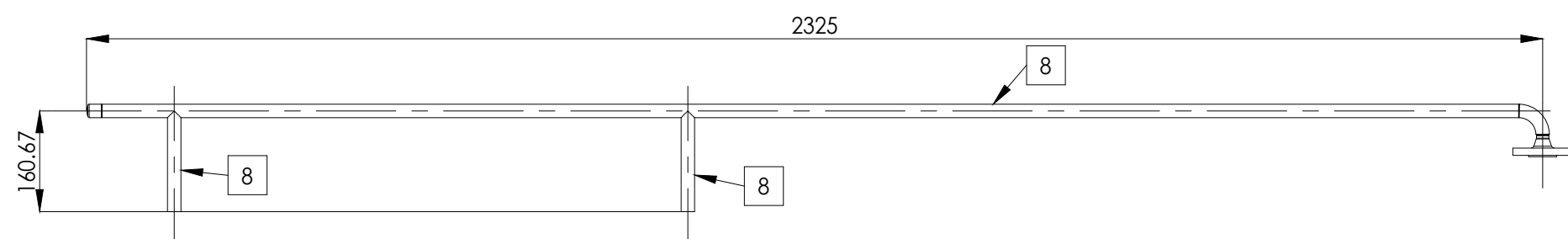
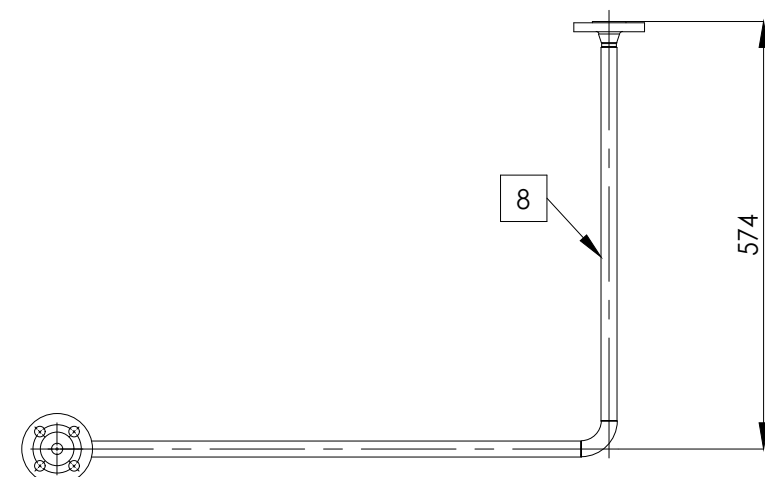

SPOOL #3 - QTY: 1

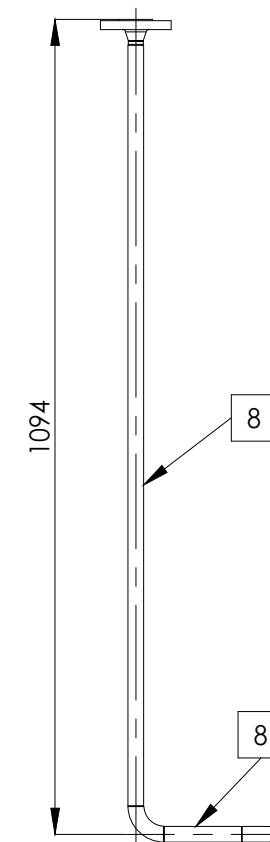

SPOOL #6 - QTY: 1

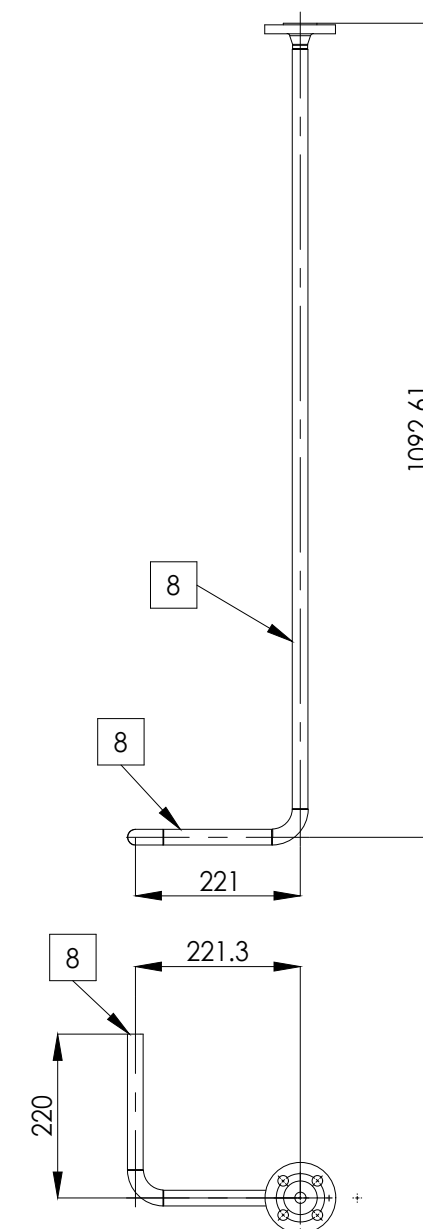
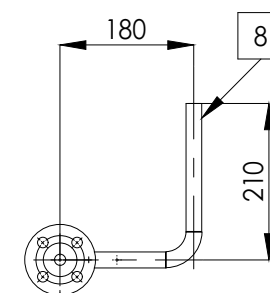

SPOOL #7 - QTY: 1

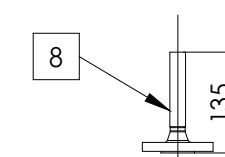

SPOOL #4 - QTY: 2

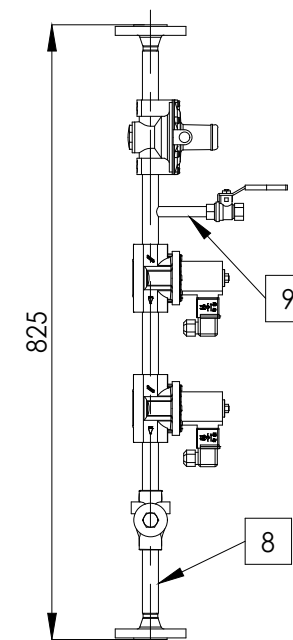

SPOOL #5 - QTY: 2

Rev.	Modification										Name		Date
This drawing is property of INSERTEC. Must not be copied or transferred to third parties in any way without written authorization.													
Tolerance for dimensions without tol. according to ISO 2768-mK									Name		Date	Material	
More than	0.5	3	6	30	120	400	1000	2000	Draw	J.J.R.R	01/12/2025	CARBON STEEL Weight (kg) 50	
Less	3	6	30	120	400	1000	2000	4000	Checked	O.A.P.M.	01/12/2025		
Machine Tool	± 0.1		± 0.1	± 0.2	± 0.3	± 0.5	± 0.8	± 1.2	± 2	Verified	B.U.		02/12/2025
Welded			± 0.5	± 1	± 1.5	± 2	± 3	± 4	± 6				
Customer:									Format:		Title		
ALINVEST									A2		ALINVEST TMT (FVRB-2,7-25) IGNITION ROUTE		
									Scale:				
<div>insertec</div> <div>Furnaces & Refractories</div>									Project		Part Number		Revision
									Methode:				2558-3321-TMT-CBS01-GEN01-21
									Customer Number		Sheet		
									-		2/2		